

# motoBOX

---

## LOS ANGELES ~ SAN FRANCISCO EST. MMXIII

- Step 1. Remove One bolt underneath Passenger Seat and remove passenger seat.
- Step 2. Remove Rider Seat.
- Step 3. Remove 2 bolts and plastic bracket that holds on to the ecu underneath the riders seat.



**Picture used as reference only**

- Step 4. Disconnect the 6 pin plug lead harness that comes from the riders seat underneath ecu.
- Step 5. Remove all 4 collar bolts that holds on the the fender underneath the subframe.

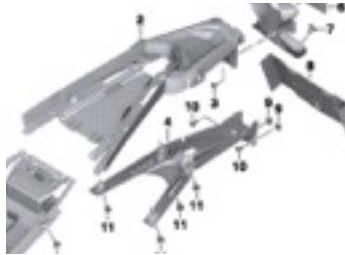

**Picture used as reference only**

- Step 6. Loosen 4 bolts that hold the ecu cradle underneath riders seat. ***Do Not remove bolts***



**Picture used as reference only**



---

LOS ANGELES ~ SAN FRANCISCO  
EST. MMXIII

Step 7. With open end on the left side, place block off underneath and install two 5mm bolts and washers at the front of the block off (near ecu).

Step 8. Run the plug and wire through the open end.

Step 9. Holding on to the block off, place the license plate holder underneath at the rear of the block off and install two 5mm bolts with washers.

Step 10. Connect direct connect plug.

**For riders that are running a passenger seat with out passenger pegs (subframe) Follow the next steps.**

Step 11. Cut plastic hooks on plastic bracket that holds down the ecu.

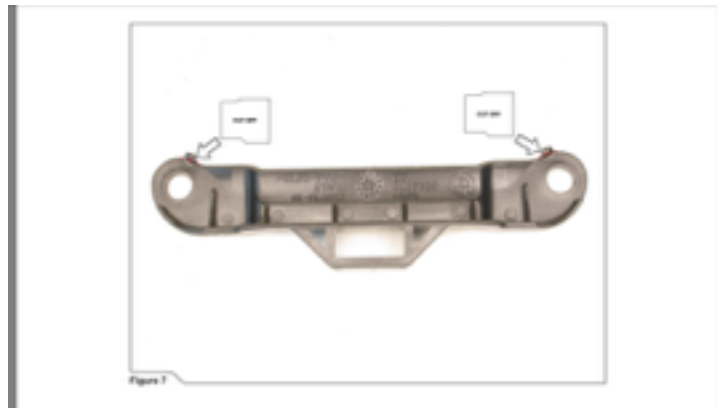

**Picture used as reference only**

Step 12. Place Motobox passenger seat bracket Underneath the ecu bracket.

Step 13. Re- install the 2 oem bolts.